

# SOCIAL IMPACT in THE SCOTTISH BORDERS



# PROJECTS

**£86.5m**

## Complete

Earlston Primary School  
Jedburgh Grammar Campus  
Roxburgh Street Health Care Centre  
Kelso High School  
Galashiels Transport interchange  
Duns Primary School  
SAS Ambulance Station – Melrose  
Lauder Health Centre

**£124m**

## In Construction

Galashiels Academy  
Peebles High School

**£93m**

## In Development

Mountain Bike Innovation Centre  
Hawick High School  
Tweedbank Care Village  
Tweedbank Offices



# COMMUNITY BENEFITS DELIVERED

On projects undertaken with various partners in the Scottish Borders, including Scottish Borders Council, NHS Borders and Scottish Ambulance Service, we have delivered a range of Community Benefits:



**61**  
NEW  
JOBS  
created

**15**



Professional  
Employment,  
including  
**GRADUATES**

**4651**



**School, Site  
& FE VISITS**

Tailored visits are arranged locally to best suit young people's needs. Whether it's Safety Sam presentations in Primary Schools or a tour of a building under construction for architecture students at university, these visits ensure maximum potential is realised from having construction projects in the community.

**61**



New and Existing  
**TRAINEES &  
APPRENTICESHIPS**

Work placements are arranged locally so pupils and students can gain valuable experience in a live site environment.

Placements are also offered within our supply chain, e.g. with designers, promoting the range of industry careers offered.

We are increasingly aiming to widen the breadth of experience to show the diverse opportunities available in the industry.

**682**  
**School, Site  
& Further  
Education  
WORK  
PLACEMENT  
DAYS**

## EXCEEDING TARGETS



We set ourselves ambitious targets in relation to community benefits and in the Scottish Borders, we are exceeding these:

**290**

More days provided for  
**WORK PLACEMENTS**

**34**

More  
**NEW JOBS**

**4125**

More  
**VISITS**

**45**

More new & existing  
**APPRENTICESHIPS**

## SCOTTISH SMES SUPPORTED THROUGH INFRASTRUCTURE PROJECTS IN THE SCOTTISH BORDERS

We're keen to ensure that a local supply chain is used during construction, with Meet the Buyer events held to give small businesses and individuals the opportunity to get involved.

**77% of construction work packages on completed projects in the Scottish Borders, were by Scottish SMEs.**

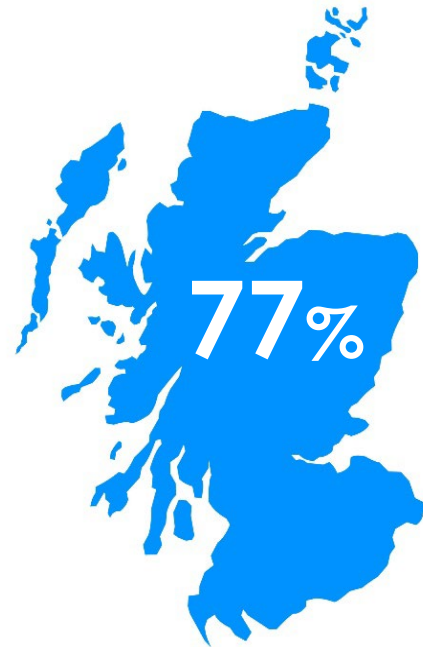

# NEW SOCIAL IMPACT MEASUREMENTS

All new projects since April 2020 have been developed and tendered using social impact measurements (SFT TOMs). The social impact is reported and measured in the Social Value Portal (SVP) system and when projects are complete, we can provide detailed reports on the social impact being delivered locally. All current projects under construction in the Borders have, and will be, developed using this method.

Many of the categories are similar, including curriculum support, site visits etc. however the measurements may vary under SFT TOMs eg. curriculum support was number of pupils under the original Community Benefit KPIs however it is recorded as staff hours with SFT TOMs.

You can see below and on the next page, some social impact figures from the completed Earliston Primary and those projects currently under construction:



**44**

**NEW JOBS**

**£16,231**

Donations in Kind to  
**LOCAL  
COMMUNITY  
PROJECTS**

**2011**

**WEEKS**



New and Existing  
**TRAINEES &  
APPRENTICESHIPS**

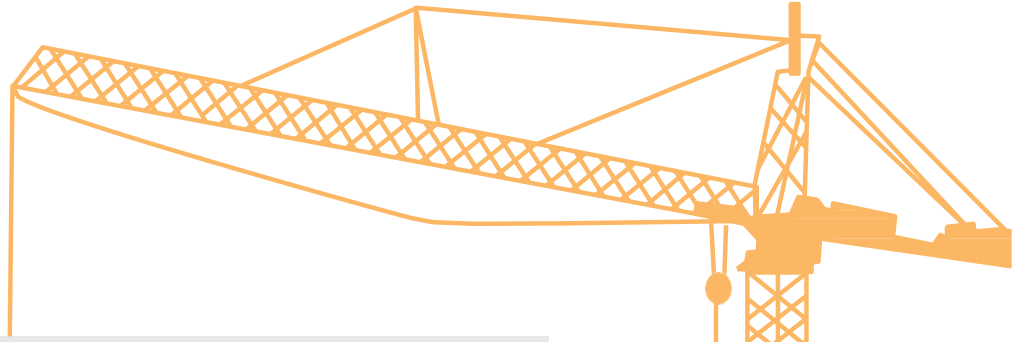

**31** WEEKS

MEANINGFUL

WORK  
PLACEMENTS

**224**

HOURS

CURRICULUM  
SUPPORT  
FOR SCHOOLS & COLLEGES

**45** HOURS

STAFF VOLUNTEERING

**386**

WEEKS

GRADUATES  
on contract

**895**

HOURS

EXPERT BUSINESS  
ADVICE

FULL TIME LOCAL PEOPLE  
EMPLOYED

**79**

To Supply Chain SMEs &  
Third Sector Organisations

**45** SITE VISITS For Schools, Colleges & Local Residents

# SUPPORTING LOCAL COMMUNITY ACTIVITIES



On all projects we aim to ensure local communities benefit from work being delivered in their area. This includes supporting local events and groups and can take many forms including donations of cash, equipment, expertise and time.

Here are just some examples of how communities in the Scottish Borders have benefited:

- ✓ **£1200 sponsorship for the Sustainable Construction Category at the Borders College Awards.**
- ✓ Donating a cabin (and helping clean and paint) to the local football team in Earlston to use as a girls' changing room.
- ✓ **£1000 sponsorship for Borders College graduation day.**
- ✓ Securing a generous supply chain donation of a steel container for the local community council in Earlston to keep the Christmas lights stored securely.
- ✓ **Assisting the local DWP office in Galashiels with their Get into Construction Programme.**
- ✓ Carrying out local litter picks in Duns.
- ✓ **Supporting a time capsule project with local youth group TD1 in Galashiels.**
- ✓ Filling potholes on the road to the local rugby club in Duns.
- ✓ **Site staff assisting pupils with interviews for school newsletters in Kelso and mock interviews in Duns, as well as supporting STV news group visits and careers fairs in Jedburgh.**
- ✓ Sponsoring local rotary events in Duns.

- ✓ **Sponsoring the auction of a chocolate train raising money for Cash for Kids as part of the Borders Railway project.**
- ✓ Assisting the local Duns Golf Course by an engineer spending time ratifying holes.
- ✓ **Donating around 200 toys to the Borders Mission Christmas appeal.**
- ✓ Sponsorship of the Jedburgh Games.
- ✓ **Donations to a local pipe band in Jedburgh.**
- ✓ Donation to Borders College Charity Golf Tournament.
- ✓ **Facilitating Doors Open Day public tours on site in Jedburgh (the fastest selling site in the country to allocate all tickets).**





## WORK EXPERIENCE TO EMPLOYMENT & UNIVERSITY

Colin Peters attended Earlston High School in the Scottish Borders and started his journey doing work experience in East Lothian on our Wallyford Community Campus project. He is now a trainee Quantity Surveyor with Morrison Construction and is undertaking a four year course with Heriot Watt University. Colin explains his career pathway:

*"I enjoyed my work experience on a Hub project in East Lothian and realised that I definitely wanted a career in the construction industry so I applied for various roles and was also considering further education. I kept in touch with the Morrison Construction team and they contacted me this year as an opportunity became available to work nearer to home in the Borders and also be supported through University."*

*"I am now a trainee Quantity Surveyor and split my time between the Earlston Primary and Galashiels Academy projects. Although I am studying one day a week, I am gaining a lot of experience on site which for me is much better than attending university full time as I'm seeing things in real life rather than on a piece of paper."*

*"I think it's great that these types of opportunities are available to young people – I'm glad I did my work experience on site as it led to me starting a career in the industry straight out of school and I'm looking forward to where this will take me in the future."*

# COLLABORATION

Whilst delivering two new state of the art learning spaces at similar timescales in Peebles and Galashiels, we wanted to ensure that across a number of workstreams, collaboration is key and that we drive synergies to allow for maximum efficiency. To this end a Collaboration Forum was set up, which runs across the workstreams of design, quality, LEIP, commercial, social impact and communications.

Meeting regularly, teams from Hub, Scottish Borders Council and both Morrison and BAM Construction, work together to ensure the cross fertilisation of ideas and to identify opportunities for collaboration.

Even before starting on site, we have worked together across the supply chain to hold joint meet the buyer events involving both contractors (events that would normally be held individually) to offer local SMEs wider access to work packages. We have also attended regional Supplier Development Programme meet the buyer events to allow us to talk to local individuals and businesses about opportunities that are available on projects in the Borders.

We have also shared best practice around social impact activities to ensure that we are contributing as effectively as possibly to community wealth building.





# **SOCIAL & ECONOMIC VALUE DELIVERED**

**Galashiels Academy**

**£8.8m**

**Peebles High School**

**£3.4m**

**Earlston Primary School**

**£812k**



## TESTIMONIALS

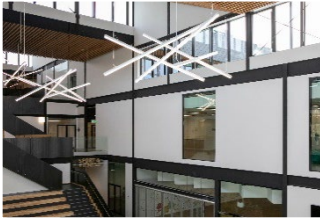

***“I live in Galashiels and saw a Meet the Buyer event for the Gala Transport Interchange advertised locally. I’m so glad I did as it change my life!”***

Ritchie, taken on as a Graduate QS and was supported through University whilst working for Morrison Construction.

***“I went to the old Kelso High as did my children. It’s amazing watching the progress of the build as we’re serving the workers on site. I think people here appreciate that we use local shops and local produce.”***

Mandy, Juicy Meat Co – site catering for Kelso High

***“I went to Kelso High School and my mother still lives just across the road from the site, so this is as local as you can get for me. The new building is going to make such a difference to the school and the community so it’s great to be part of the project making it happen.”***

Wayne, General Labourer, Keyes Bros

***“As a local Jedburgh based company, we are delighted to be involved in the enabling works, preparing the site for the building of what will be a fantastic new campus.”***

***“It’s great to see opportunities being offered to the local community and I’m proud that RJT Excavations gets to play its part in a project which will have a long lasting legacy for the town.”***

Garry – Managing Director, RJT Excavations, Jedburgh Campus

Find out more at our website:  
[www.hubsoutheast.co.uk](http://www.hubsoutheast.co.uk)

**Hub South East Scotland Ltd**  
8 Melville Street  
Edinburgh EH3 7NS  
T. 0131 226 0900  
E. [mail@hubsoutheast.co.uk](mailto:mail@hubsoutheast.co.uk)  
[www.hubsoutheast.co.uk](http://www.hubsoutheast.co.uk)

